

Code	Mode	Drawing Title	Scale @A0	Revision
VAL DI Fiemme Cluster				
TESERO CROSS-COUNTRY STADIUM - OLY Cross-Country, Nordic Combined / PAR Para Biathlon, Para Cross-Country				
41_TCS_OLY_00_AL0	OLY	Aerial View	1:1500	3
41_TCS_OLY_00_AL1	OLY	Masterplan	1:1000	3
41_TCS_PAR_00_AL0	PAR	Aerial View	1:1500	3
41_TCS_PAR_00_AL1	PAR	Masterplan	1:1000	3
Predazzo Ski Jumping Stadium - OLY Ski Jumping, Nordic Combined				
42_Psj_OLY_00_AL0	OLY	Aerial View	1:1000	3
42_Psj_OLY_00_AL1	OLY	Masterplan	1:1000	3
Predazzo Olympic & Paralympic Village - OLY / PAR				
43_Prv_NCO_00_AL0	OLY	Aerial View	1:500	3
43_Prv_NCO_00_AL1	OLY	Masterplan	1:500	3
43_Prv_NCP_00_AL0	PAR	Aerial View	1:500	3
43_Prv_NCP_00_AL1	PAR	Masterplan	1:500	3

© 2021 FONDAZIONE MILANO CORTINA 2026 - ALL RIGHTS RESERVED.
THIS DRAWING IS THE PROPERTY OF THE ORGANISING COMMITTEE FOR THE
2026 OLYMPIC AND PARALYMPIC WINTER GAMES AND IS STRICTLY CONFIDENTIAL.
IT IS NOT TO BE DISTRIBUTED, REPRODUCED OR ALTERED IN ANY WAY AS WHOLE OR IN PARTS
WITHOUT WRITTEN PERMISSION OF FONDAZIONE MILANO CORTINA 2026.
FONDAZIONE MILANO CORTINA 2026 SHALL HAVE NO RESPONSIBILITY OR LIABILITY FOR THE
SUITABILITY, ACCURACY, OR COMPLETENESS OF THE INFORMATION IT CONTAINS.
ALL DIMENSIONS AND LEVELS MUST BE VERIFIED ON SITE AND ANY DISCREPANCIES ARE TO BE
REPORTED TO FONDAZIONE MILANO CORTINA 2026 BEFORE PROCEEDING WITH ANY RELATED WORKS.

TESERO CROSS-COUNTRY STADIUM Cross-Country, Nordic Combined

LEGEND

AREA / FUNCTION	ROUTE / FLOW		
	Pedestrian	Vehicular	Entry Point
Field Of Play			
Athletes			
Olympic / Paralympic Family			
In Venue Hospitality *Experience			
Spectators			
Broadcast			
Press			
Security			
Venue Operations			
Ceremonies			
Unavailable / Not to be used			
Multiple Client Groups			

	Parking Area		Venue Secure Perimeter
	Load Zone		Internal Division / Fence
	PSA Pedestrian Screening Area		Inner Perimeter
	VSA Vehicles Screening Area		Existing Division / Fence
	Metro Station		

REVISIONS

No.	STATUS	DATE
1	Venue Design Book 1	15/11/2021
2	Venue Design Book 2	28/10/2022
3	Venue Design Book 3	15/12/2023

NOTES

FOP		Classic 2.50 km		Free 2.50 km
		Classic 3.30 km (addition)		Free 3.30 km
		Classic 3.75 km		Free 3.75 km

KEY PLAN

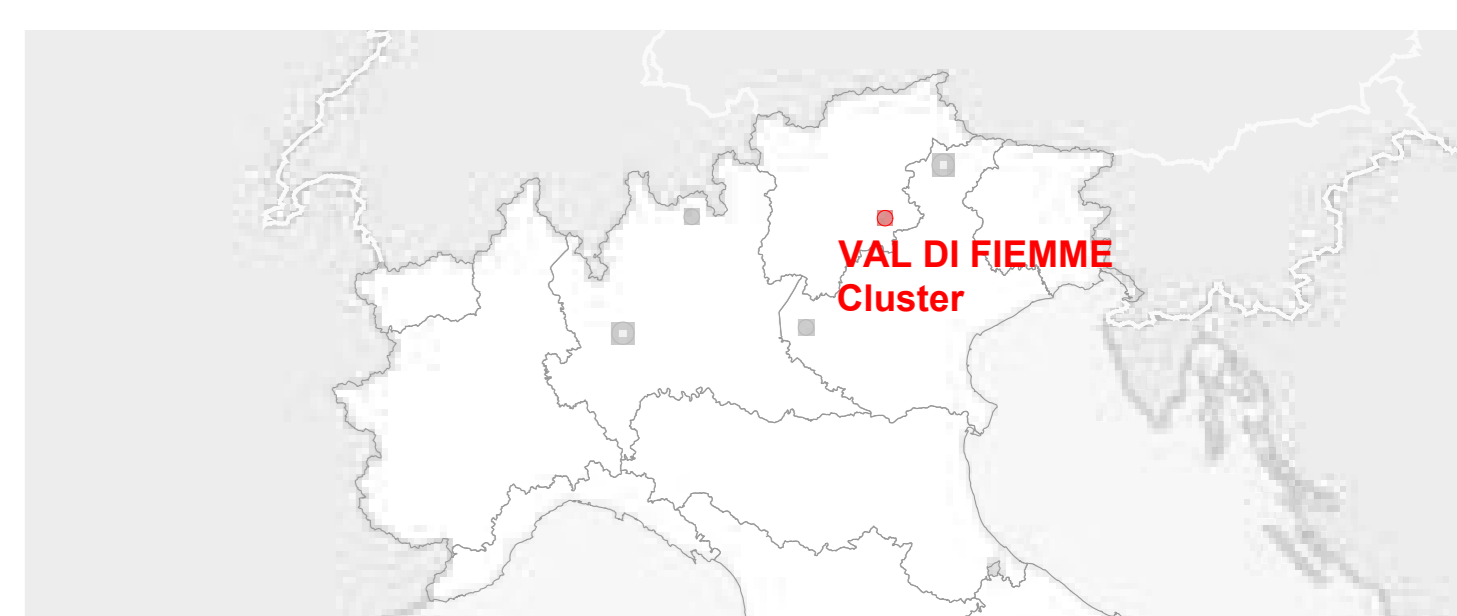

DRAWING CODE

1_TCS_OLY_00_AL0

DRAWING TITLE	DATE
Olympic Mode AERIAL VIEW	15/12/2023

STATUS	REVISION No.
VENUE DESIGN BOOK 3	3

SCALE @A0	
1:1500	

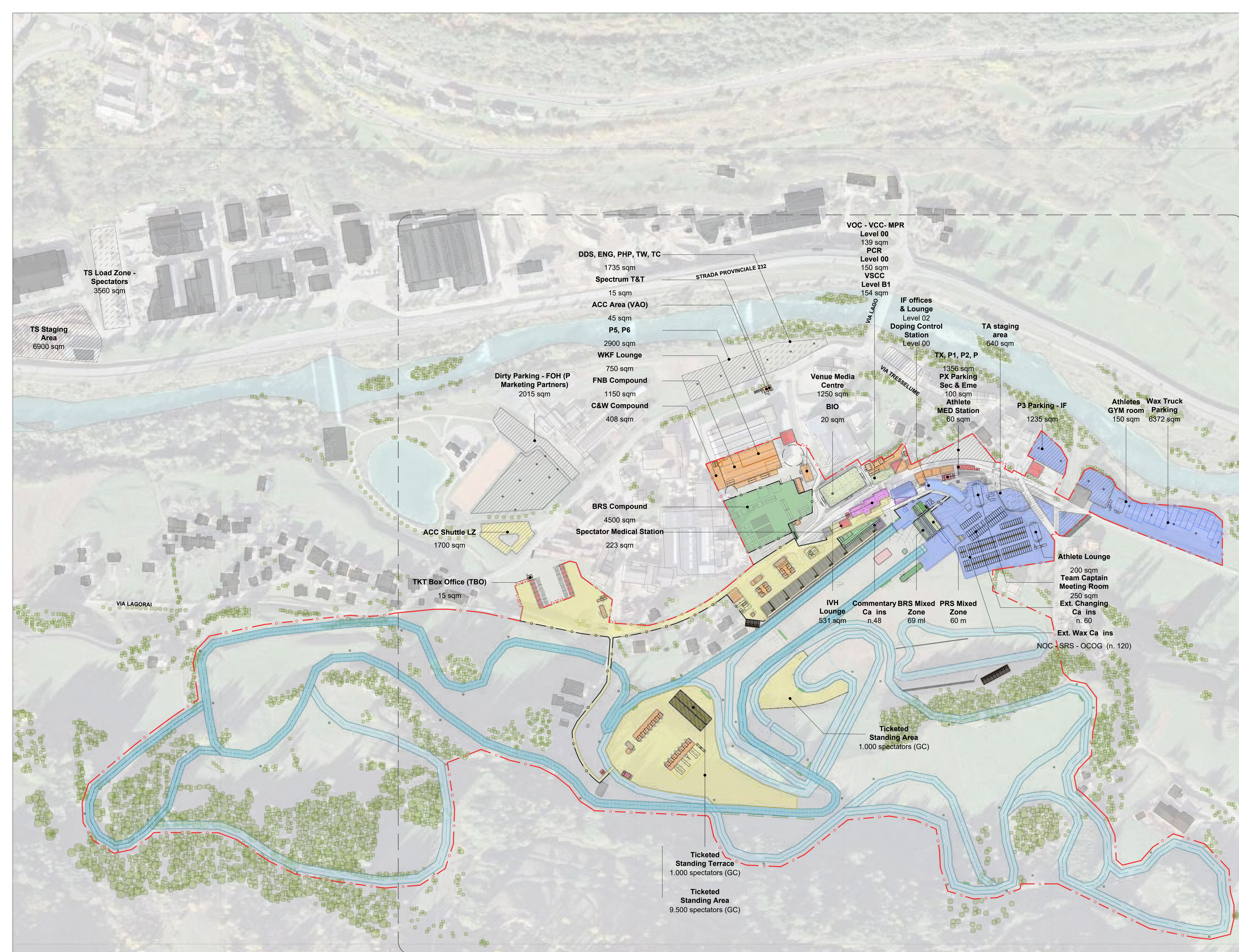

1_TCS_OLY_00_AL1



FONDAZIONE MILANO CORTINA 2026
ORGANISING COMMITTEE FOR THE
OLYMPIC AND PARALYMPIC WINTER GAMES

PIAZZA TRE TORRI, 3 - 20145 MILANO, ITALIA
www.milanocortina2026.org

© 2021 FONDAZIONE MILANO CORTINA 2026 - ALL RIGHTS RESERVED.
THIS DRAWING IS THE PROPERTY OF THE ORGANISING COMMITTEE FOR THE
2026 OLYMPIC AND PARALYMPIC WINTER GAMES AND IS STRICTLY CONFIDENTIAL.
IT IS NOT TO BE DISTRIBUTED, REPRODUCED OR ALTERED IN ANY WAY AS WHOLE OR IN PARTS
WITHOUT WRITTEN PERMISSION OF FONDAZIONE MILANO CORTINA 2026.
FONDAZIONE MILANO CORTINA 2026 SHALL HAVE NO RESPONSIBILITY OR LIABILITY FOR THE
SUITABILITY, ACCURACY, OR COMPLETENESS OF THE INFORMATION IT CONTAINS.
ALL DIMENSIONS AND LEVELS MUST BE VERIFIED ON SITE AND ANY DISCREPANCIES ARE TO BE
REPORTED TO FONDAZIONE MILANO CORTINA 2026 BEFORE PROCEEDING WITH ANY RELATED WORKS.

TESERO
CROSS-COUNTRY STADIUM
Cross-Country, Nordic Combined

LEGEND

AREA / FUNCTION	ROUTE / FLOW		
	Pedestrian	Vehicular	Entry Point
Field Of Play			
Athletes	Blue dashed arrow	Blue solid arrow	Blue triangle
Olympic / Paralympic Family	Blue dashed arrow	Blue solid arrow	Blue triangle
In Venue Hospitality *Experience	Purple dashed arrow	Purple solid arrow	Purple triangle
Spectators	Yellow dashed arrow	Yellow solid arrow	Yellow triangle
Broadcast	Green dashed arrow	Green solid arrow	Green triangle
Press	Red dashed arrow	Red solid arrow	Red triangle
Security	Red dashed arrow	Red solid arrow	Red triangle
Venue Operations	Orange dashed arrow	Orange solid arrow	Orange triangle
Ceremonies	Pink dashed arrow	Pink solid arrow	Pink triangle
Unavailable / Not to be used	Grey dashed arrow	Grey solid arrow	Grey triangle
Multiple Client Groups	Grey dashed arrow	Grey solid arrow	Grey triangle

[Hatched Box]	Parking Area	[Red Dashed Line]	Venue Secure Perimeter
[Hatched Box]	Load Zone	[Red Dotted Line]	Internal Division / Fence
[Red Box]	PSA Pedestrian Screening Area	[Green Dotted Line]	Inner Perimeter
[Red Box]	VSA Vehicles Screening Area	[Black Dotted Line]	Existing Division / Fence
[M Box]	Metro Station		

REVISIONS

No.	STATUS	DATE
1	Venue Design Book 1	15/11/2021
2	Venue Design Book 2	28/10/2022
3	Venue Design Book 3	15/12/2023

NOTES

FOP	Classic 2.50 km	Free 2.50 km
	Classic 3.30 km (addition)	Free 3.30 km
	Classic 3.75 km	Free 3.75 km



DRAWING CODE
1_TCS_OLY_00_AL1

DRAWING TITLE
Olympic Mode
MASTERPLAN

DATE
15/12/2023

STATUS
VENUE DESIGN BOOK 3

REVISION No.
3

SCALE @A0
1:1000

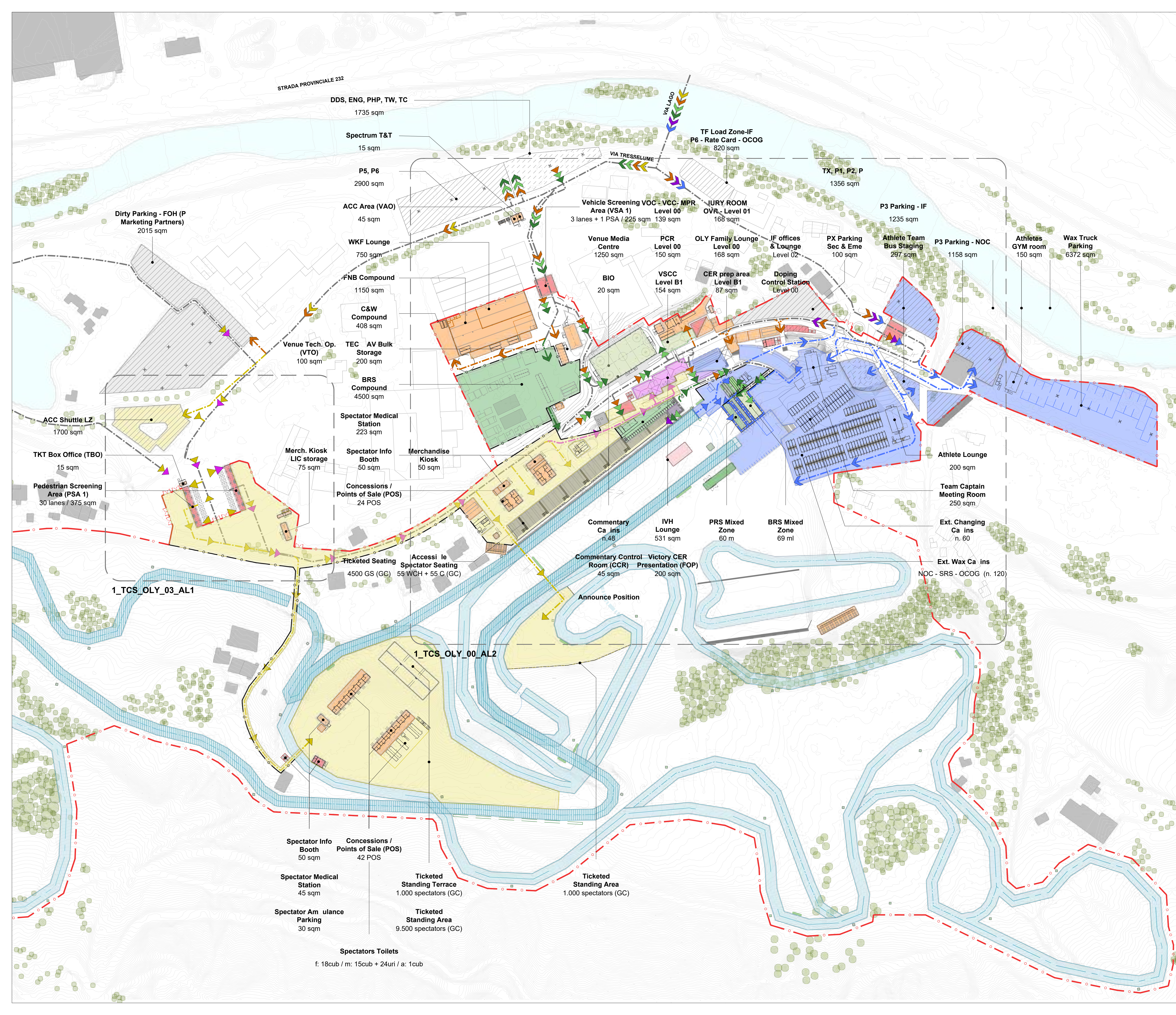

© 2021 FONDAZIONE MILANO CORTINA 2026 - ALL RIGHTS RESERVED.
THIS DRAWING IS THE PROPERTY OF THE ORGANISING COMMITTEE FOR THE
2026 OLYMPIC AND PARALYMPIC WINTER GAMES AND IS STRICTLY CONFIDENTIAL.
IT IS NOT TO BE DISTRIBUTED, REPRODUCED OR ALTERED IN ANY WAY AS WHOLE OR IN PARTS
WITHOUT WRITTEN PERMISSION OF FONDAZIONE MILANO CORTINA 2026.
FONDAZIONE MILANO CORTINA 2026 SHALL HAVE NO RESPONSIBILITY OR LIABILITY FOR THE
SUITABILITY, ACCURACY, OR COMPLETENESS OF THE INFORMATION IT CONTAINS.
ALL DIMENSIONS AND LEVELS MUST BE VERIFIED ON SITE AND ANY DISCREPANCIES ARE TO BE
REPORTED TO FONDAZIONE MILANO CORTINA 2026 BEFORE PROCEEDING WITH ANY RELATED WORKS.

TESERO CROSS-COUNTRY STADIUM Para Biathlon, Para Cross-Country

LEGEND

AREA / FUNCTION	ROUTE / FLOW		
	Pedestrian	Vehicular	Entry Point
Field Of Play			
Athletes			
Olympic / Paralympic Family			
In Venue Hospitality *Experience			
Spectators			
Broadcast			
Press			
Security			
Venue Operations			
Ceremonies			
Unavailable / Not to be used			
Multiple Client Groups			

	Parking Area		Venue Secure Perimeter
	Load Zone		Internal Division / Fence
	PSA Pedestrian Screening Area		Inner Perimeter
	VSA Vehicles Screening Area		Existing Division / Fence
	Metro Station		

REVISIONS

No.	STATUS	DATE
1	Venue Design Book 1	15/11/2021
2	Venue Design Book 2	28/10/2022
3	Venue Design Book 3	15/12/2023

NOTES

FOP
 Paralympic FoP

KEY PLAN

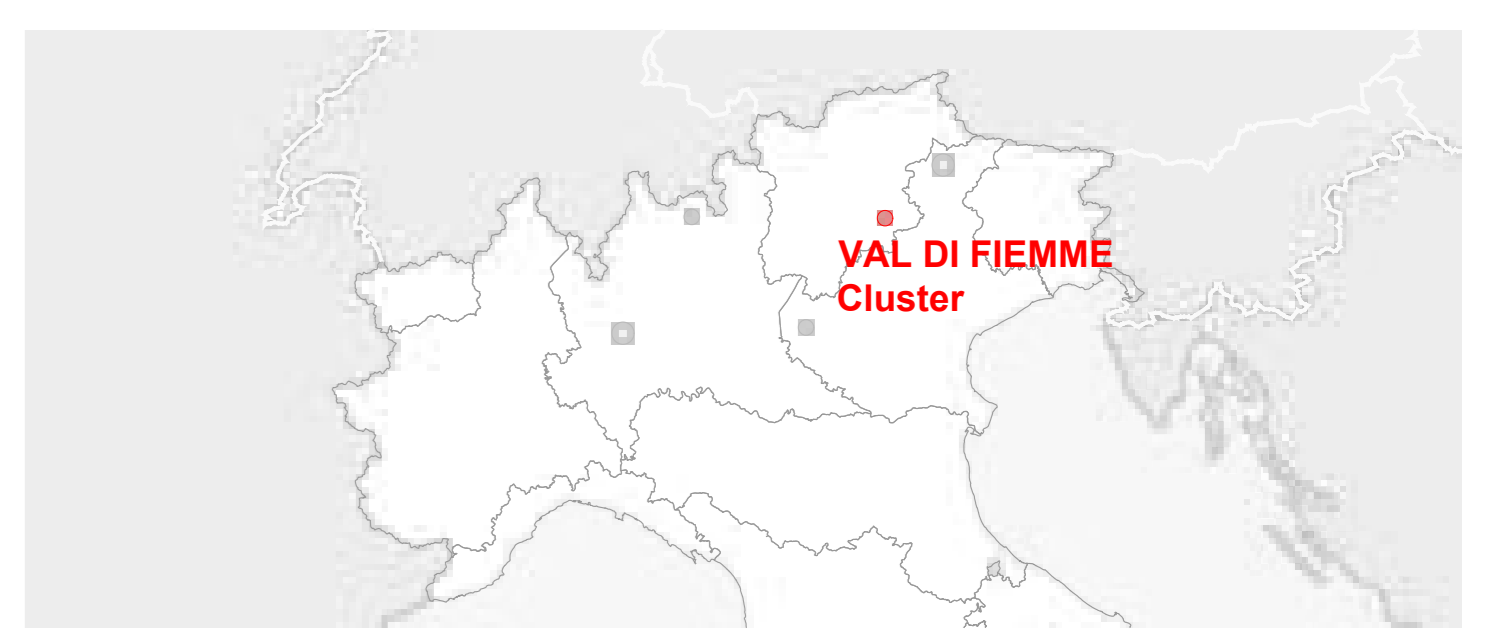

DRAWING CODE

1_TCS_PAR_00_AL0

DRAWING TITLE	DATE
Paralympic Mode AERIAL VIEW	15/12/2023

STATUS	REVISION No.
VENUE DESIGN BOOK 3	3

SCALE @A0

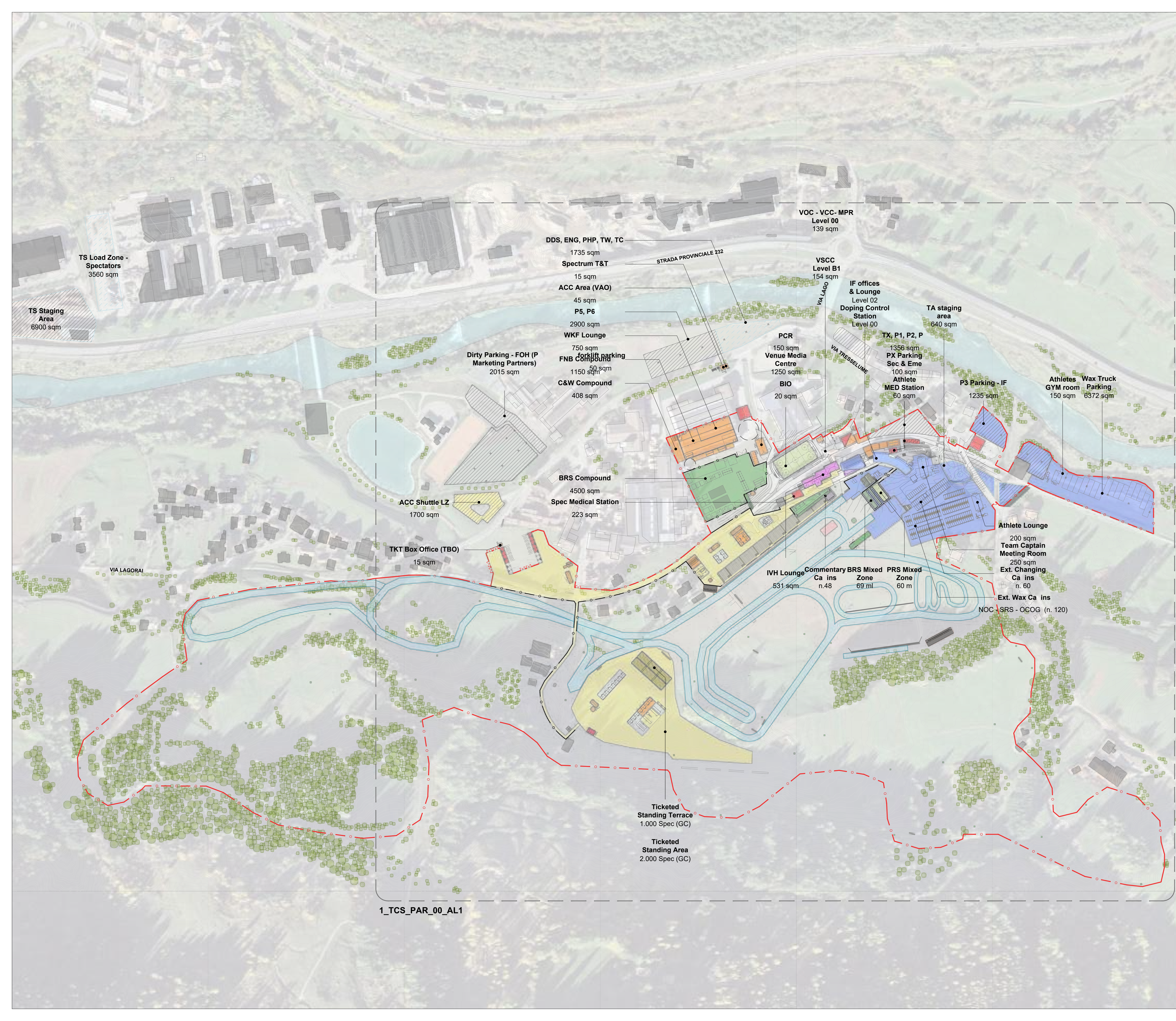
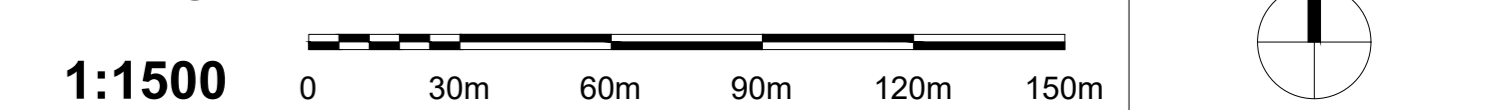

1_TCS_PAR_00_AL1

© 2021 FONDAZIONE MILANO CORTINA 2026 - ALL RIGHTS RESERVED.
THIS DRAWING IS THE PROPERTY OF THE ORGANISING COMMITTEE FOR THE
2026 OLYMPIC AND PARALYMPIC WINTER GAMES AND IS STRICTLY CONFIDENTIAL.
IT IS NOT TO BE DISTRIBUTED, REPRODUCED OR ALTERED IN ANY WAY AS WHOLE OR IN PARTS
WITHOUT WRITTEN PERMISSION OF FONDAZIONE MILANO CORTINA 2026.
FONDAZIONE MILANO CORTINA 2026 SHALL HAVE NO RESPONSIBILITY OR LIABILITY FOR THE
SUITABILITY, ACCURACY, OR COMPLETENESS OF THE INFORMATION IT CONTAINS.
ALL DIMENSIONS AND LEVELS MUST BE VERIFIED ON SITE AND ANY DISCREPANCIES ARE TO BE
REPORTED TO FONDAZIONE MILANO CORTINA 2026 BEFORE PROCEEDING WITH ANY RELATED WORKS.

TESERO CROSS-COUNTRY STADIUM Para Biathlon, Para Cross-Country

LEGEND

AREA / FUNCTION	ROUTE / FLOW		
	Pedestrian	Vehicular	Entry Point
Field Of Play			
Athletes			
Olympic / Paralympic Family			
In Venue Hospitality *Experience			
Spectators			
Broadcast			
Press			
Security			
Venue Operations			
Ceremonies			
Unavailable / Not to be used			
Multiple Client Groups			
Parking Area			
Load Zone			
Pedestrian Screening Area			
PSA			
Vehicles Screening Area			
Metro Station			
Venue Secure Perimeter			
Internal Division / Fence			
Inner Perimeter			
Existing Division / Fence			

REVISIONS

No.	STATUS	DATE
1	Venue Design Book 1	15/11/2021
2	Venue Design Book 2	28/10/2022
3	Venue Design Book 3	15/12/2023

NOTES

FOP
Paralympic FoP

KEY PLAN

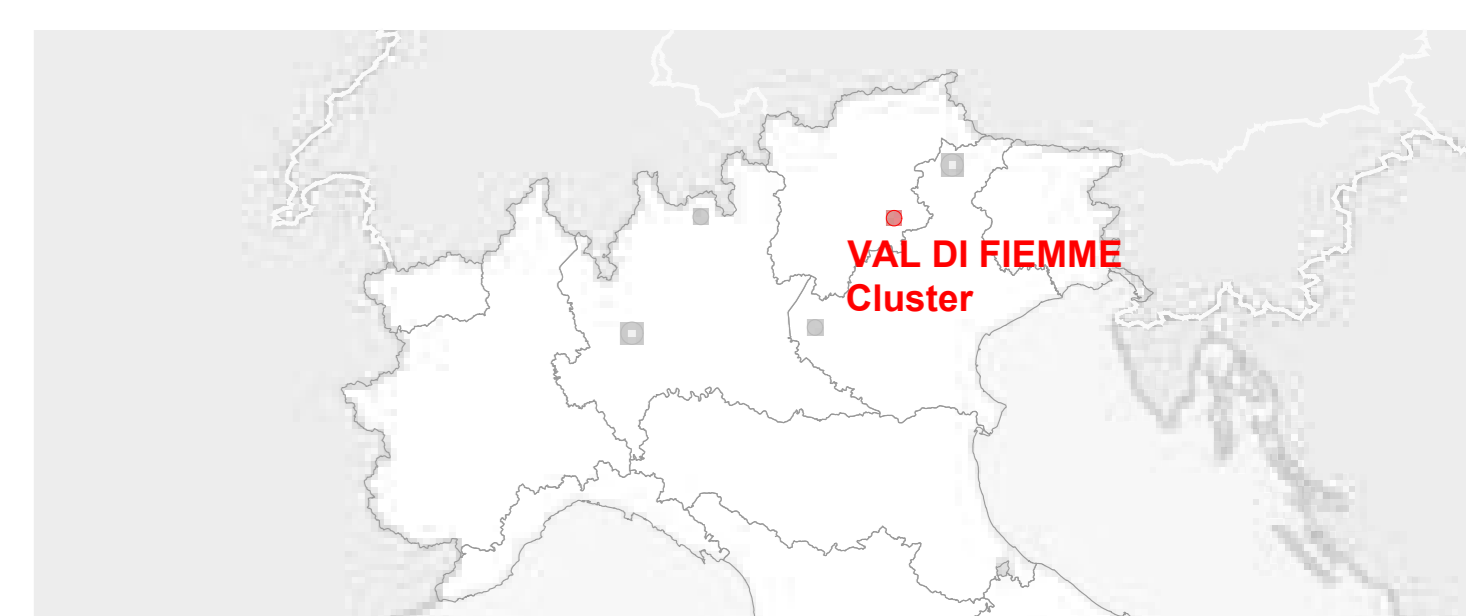

DRAWING CODE

1_TCS_PAR_00_AL1

DRAWING TITLE

**Paralympic Mode
MASTERPLAN** DATE
15/12/2023

STATUS

VENUE DESIGN BOOK 3 REVISION No.
3

SCALE @A0

1:1000

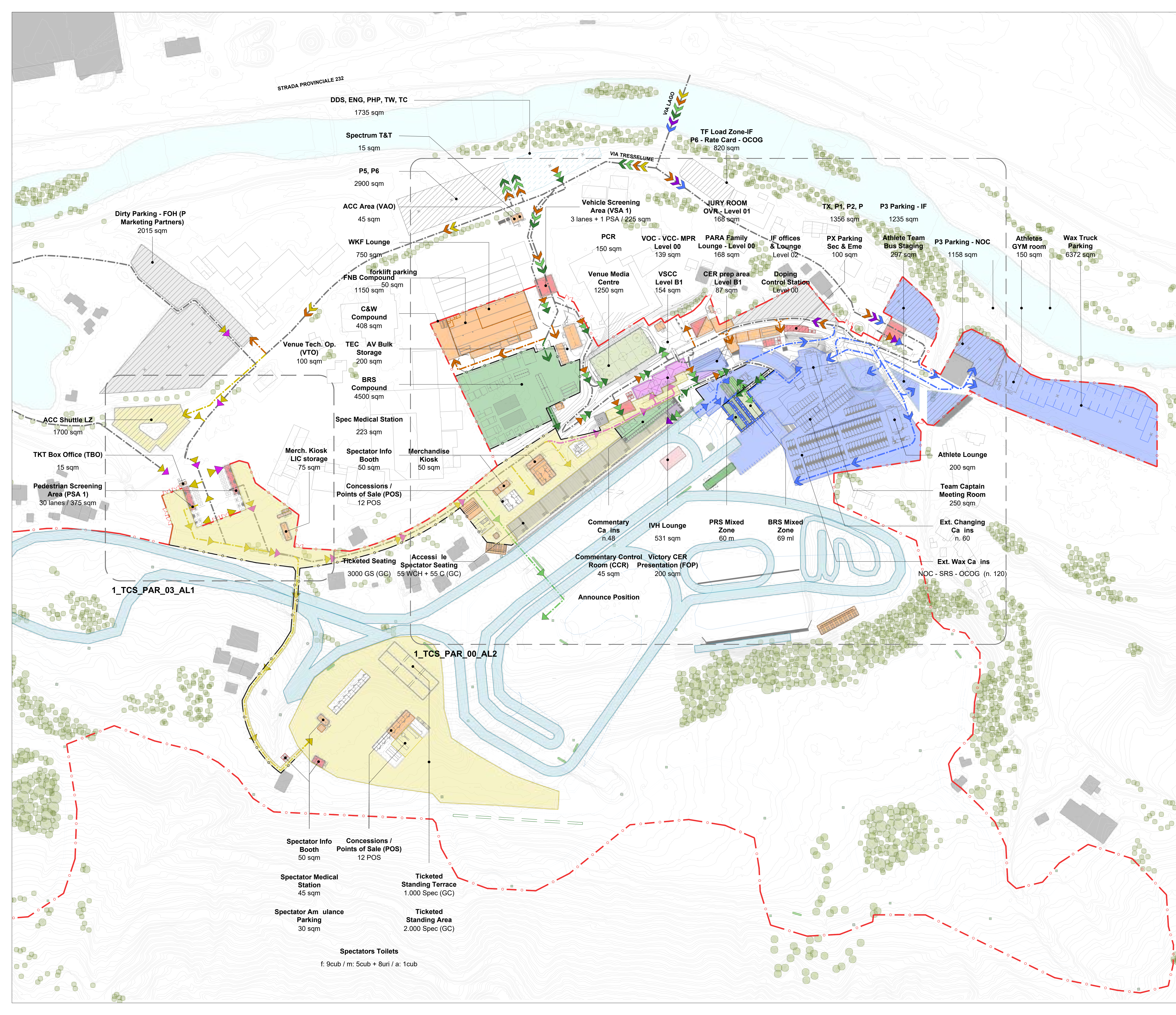

PREDAZZO SKI JUMPING STADIUM Ski Jumping, Nordic Combined

LEGEND

AREA / FUNCTION	ROUTE / FLOW		
	Pedestrian	Vehicular	Entry Point
Field Of Play	→	→	→
Athletes	→	→	→
Olympic / Paralympic Family	→	→	→
In Venue Hospitality *Experience	→	→	→
Spectators	→	→	→
Broadcast	→	→	→
Press	→	→	→
Security	→	→	→
Venue Operations	→	→	→
Ceremonies	→	→	→
Unavailable / Not to be used	→	→	→
Multiple Client Groups	→	→	→

	Parking Area		Venue Secure Perimeter
	Load Zone		Internal Division / Fence
	PSA Pedestrian Screening Area		Inner Perimeter
	VSA Vehicles Screening Area		Existing Division / Fence
	Metro Station		

REVISIONS

No.	STATUS	DATE
1	Venue Design Book 1	15/11/2021
2	Venue Design Book 2	28/10/2022
3	Venue Design Book 3	15/12/2023

NOTES

KEY PLAN

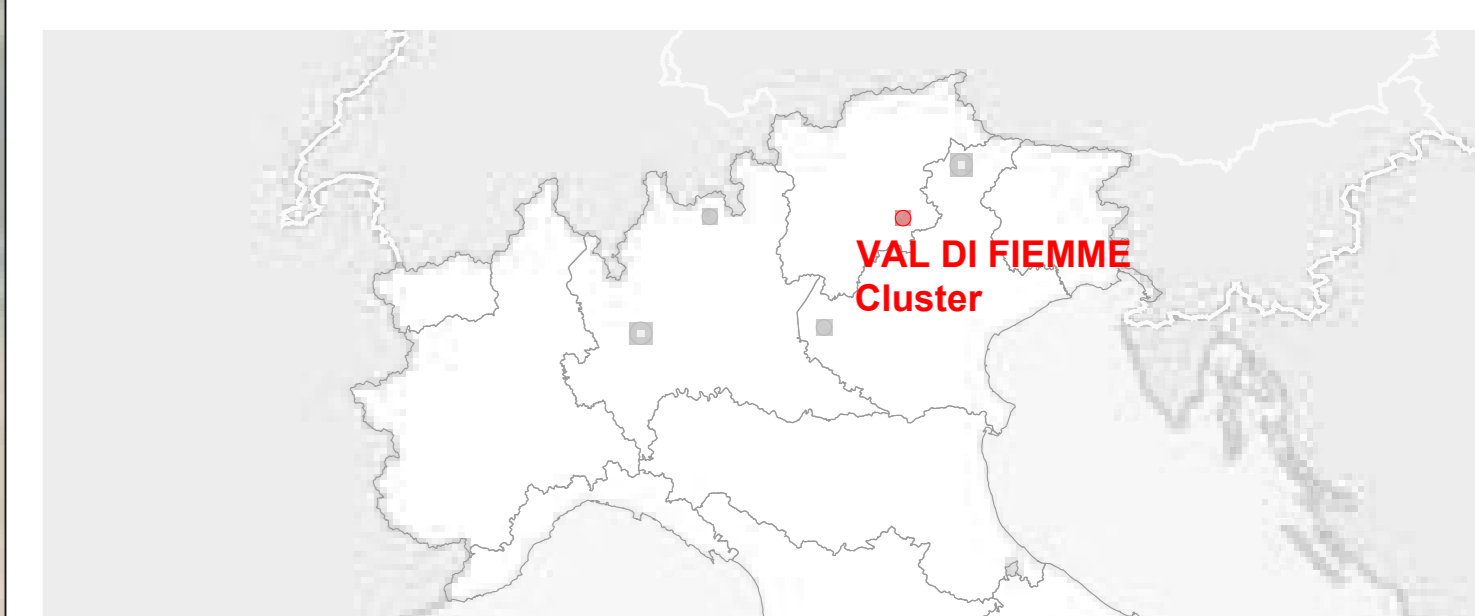

DRAWING CODE

2_P SJ_OLY_00_AL0

DRAWING TITLE	DATE
Olympic Mode AERIAL VIEW	15/12/2023

STATUS	REVISION No.
VENUE DESIGN BOOK 3	3

SCALE @A0



BAITA ATLETI
IF OFFICES

1 M+F+A Toilets	36 sqm
2 IF Offices	40 sqm
3 IF Work Area	45 sqm
4 IF Break Area	25 sqm
5 IF Storage	15 sqm
6 IF meeting room	

Vehicle Screening Area (VSA2)
2 lanes + 1PSA / 150 sqm

TA Load Zone - Athletes and NOCF
TF Load Zone-International Federations
250 sqm

P3 Parking - IF
290 sqm

THLETE COMPOUND
SPT / DOP / MED

1 Athlete Medical Station	45 sqm
2 Doping Control Station	80 sqm
3 Wax cabins	80 U
4 M+F Toilets	
5 Team Captain Meeting	150 sqm
6 Race Office	50 sqm
7 Athletes gym	50 sqm
8 Athletes Lounge	150 sqm

Concessions / Points of Sale (POS)
9 POS

Ticketed Standing Area
n.1200 / 1200 sqm

Comms. Ca ins
n.45

Cleaning & Waste Compound
492 sqm

Site Management Compound
721 sqm

OF / MPS / PRS / MED / CER
LB1 VMC - FOP Medical - Ceremonies
L00 VMC + IVH Lounge
L01 SPP + IVH Lounge & OF Lounge.

Ticket Resolution
16 sqm

Spectator Medical Station
39 sqm

Food & Beverage Compound
1897 sqm

WKF Lounge & Break
600 sqm

Logistic Compound
1000 sqm

VAO
45 sqm

Spectrum T&T
15 sqm

P3 / P5 / P6
1800 sqm

P3 Parking - NOC

P5 Parking - Broadcasters (OBS, MRH, ENG, PHP)

P6 Parking - Rate Card and OCOG Dedicated Vehicles



New Judges Tower: TEC / SPT / MPS

1 FoP Equipment Storage	80 sqm
2 Meteorological Office	20 sqm
3 ITO's break area	20 sqm
4 Jury Room	24 sqm
5 Competition management	45 sqm
6 M+F+A Toilets	
7 OVR - T&S	60 sqm
8 IVH Experience	25 sqm
9 Jury areas	41 sqm
10 BRS camera platform + 10 photo position	

New Upper Stations: SPT

1 Athletes Services	
2 Unisex Toilets	

New Ski Jump Towers (HS143)
SPT / MPS / BRS

1 Male & Female Toilets	6sqm
2 Equipment Control	10 sqm
3 Athletes Staging Area	10 sqm
4 Warm Up Area	35 sqm
5 IVH Experience Lounge	35 sqm
5 BRS camera platform	8 sqm

New Ski Jump Towers (HS109)
SPT / BRS

1 Male & Female Toilets	6sqm
2 Equipment Control	7sqm
3 Staging Area	7sqm
4 Warm Up Area	35sqm
5 BRS camera platform	8sqm

RES Venue Storage/ Workshop
50 sqm

Ticketed Standing Area (HS13 Sess.)
n. 1400 / 1400 sqm

Ticketed Standing Area (HS10 Sess.)
n. 1400 / 1400 sqm

Spectators Ticketed Seating
n. 1210

Workforce Check-in
75 sqm

Broadcast Compound
4065 sqm

Venue TEC Operations (VTO)
90 sqm

Tech. Storage
150 sqm

AV Bulk Storage
50 sqm

Pedestrian Screening (PSA2)
4 lanes / 50 sqm

Pedestrian Screening (PSA1)
6 lanes / 75 sqm

Vehicle Screening Area (VSA 1)
2 lanes + 1PSA / 150 sqm

Driver s Waiting
15 sqm

Box Office (TBO)
25 sqm

DDS / ENG / PHP / TW / TS
2800 sqm

DDS Load Zone
OBSTW Load Zone - Workforce
ENG Load Zone
TS Staging Area

© 2021 FONDAZIONE MILANO CORTINA 2026 - ALL RIGHTS RESERVED.
THIS DRAWING IS THE PROPERTY OF THE ORGANISING COMMITTEE FOR THE
2026 OLYMPIC AND PARALYMPIC WINTER GAMES AND IS STRICTLY CONFIDENTIAL.
IT IS NOT TO BE DISTRIBUTED, REPRODUCED OR ALTERED IN ANY WAY AS WHOLE OR IN PARTS
WITHOUT WRITTEN PERMISSION OF FONDAZIONE MILANO CORTINA 2026.
FONDAZIONE MILANO CORTINA 2026 SHALL HAVE NO RESPONSIBILITY OR LIABILITY FOR THE
SUITABILITY, ACCURACY, OR COMPLETENESS OF THE INFORMATION IT CONTAINS.
ALL DIMENSIONS AND LEVELS MUST BE VERIFIED ON SITE AND ANY DISCREPANCIES ARE TO BE
REPORTED TO FONDAZIONE MILANO CORTINA 2026 BEFORE PROCEEDING WITH ANY RELATED WORKS.

PREDAZZO SKI JUMPING STADIUM Ski Jumping, Nordic Combined

LEGEND

AREA / FUNCTION	ROUTE / FLOW		
	Pedestrian	Vehicular	Entry Point
Field Of Play	→	→	→
Athletes	→	→	→
Olympic / Paralympic Family	→	→	→
In Venue Hospitality *Experience	→	→	→
Spectators	→	→	→
Broadcast	→	→	→
Press	→	→	→
Security	→	→	→
Venue Operations	→	→	→
Ceremonies	→	→	→
Unavailable / Not to be used	→	→	→
Multiple Client Groups	→	→	→

	Parking Area
	Load Zone
	PSA Pedestrian Screening Area
	VSA Vehicles Screening Area
	M Metro Station
	Venue Secure Perimeter
	Internal Division / Fence
	Inner Perimeter
	Existing Division / Fence

REVISIONS

No.	STATUS	DATE
1	Venue Design Book 1	15/11/2021
2	Venue Design Book 2	28/10/2022
3	Venue Design Book 3	15/12/2023

NOTES

KEY PLAN

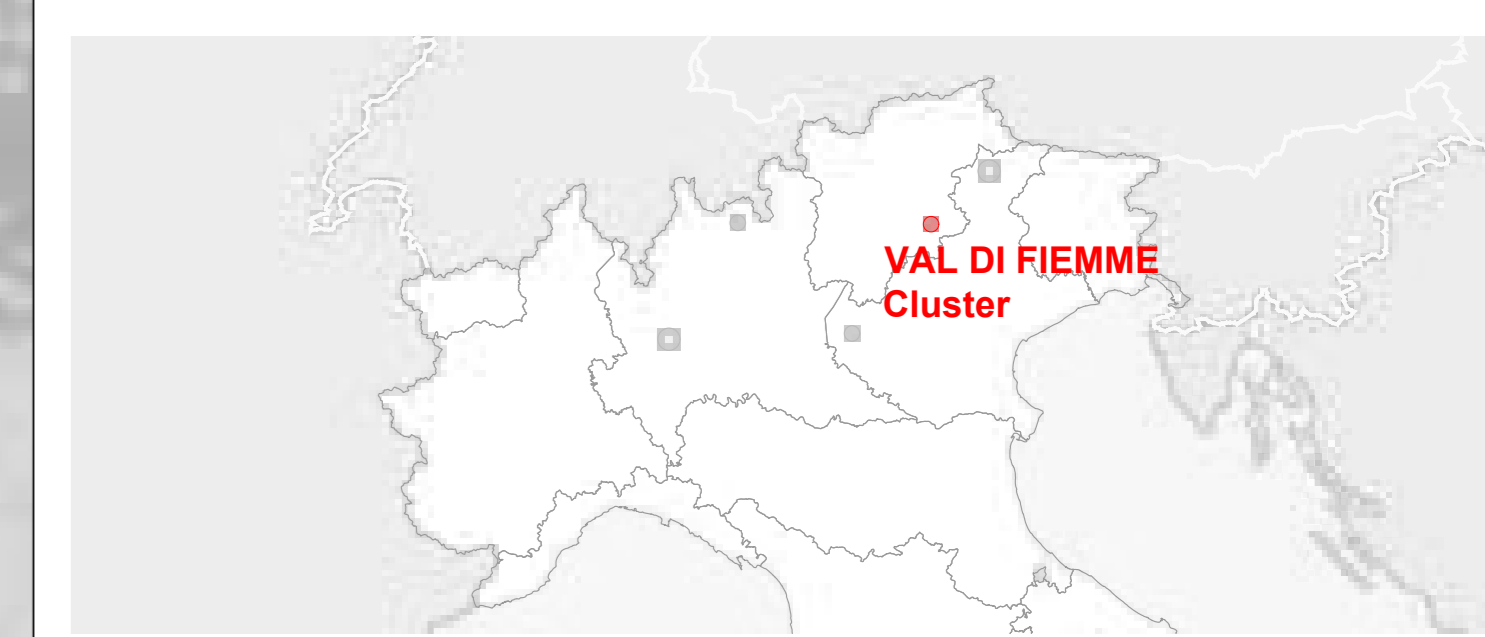

DRAWING CODE

2_PSJ_OLY_00_AL1

DRAWING TITLE	DATE
Olympic Mode MASTERPLAN	15/12/2023

STATUS	REVISION No.
VENUE DESIGN BOOK 3	3

SCALE @A0	
1:1000	

- BAITA ATLETI
IF OFFICES
- 1 M+F+A Toilets 36 sqm
 - 2 IF Offices 40 sqm
 - 3 IF Work Area 45 sqm
 - 4 IF Break Area 25 sqm
 - 5 IF Storage 15 sqm
 - 6 IF meeting room

- Vehicle Screening Area (VSA2)**
2 lanes + 1PSA / 150 sqm

- TA Load Zone - Athletes and NOCF**
TF Load Zone-International Federations
250 sqm

- THLETE COMPOUND
SPT / DOP / MED
- 1 Athlete Medical Station 45 sqm
 - 2 Doping Control Station 80 sqm
 - 3 Wax cabins 80 U
 - 4 M+F Toilets
 - 5 Team Captain Meeting 150 sqm
 - 6 Race Office 50 sqm
 - 7 Athletes gym 50 sqm
 - 8 Athletes Lounge 150 sqm

- Concessions / Points of Sale (POS)**
9 POS

- Ticketed Standing Area**
n.1200 / 1200 sqm

- Comms. Ca ins**
n.45

- Cleaning & Waste Compound**
492 sqm

- Site Management Compound**
721 sqm

- OF / MPS / PRS / MED / CER
LB1 VMC - FOP Medical - Ceremonies
L00 VMC + IVH Lounge
L01 SPP + IVH Lounge & OF Lounge.

- Ticket Resolution**
16 sqm

- Spectator Medical Station**
39 sqm

- Food & Beverage Compound**
1897 sqm

- WKF Lounge & Break**
600 sqm

- Logistic Compound**
1000 sqm

- VAO**
45 sqm

- Spectrum T&T**
15 sqm

- P3 / P5 / P6**
1800 sqm

- P3 Parking - NOC**

- P5 Parking - Broadcasters (OBS, MRH, ENG, PHP)**

- P6 Parking - Rate Card and OCOG Dedicated Vehicles**

2_PSJ_OLY_00_AL3

- New Judges Tower: TEC / SPT / MPS
- 1 FoP Equipment Storage 80 sqm
 - 2 Meteorological Office 20 sqm
 - 3 ITO's break area 20 sqm
 - 4 Jury Room 24 sqm
 - 5 Competition management 45 sqm
 - 6 M+F+A Toilets
 - 7 OVR - T&S 60 sqm
 - 8 IVH Experience 25 sqm
 - 9 Jury areas 41 sqm
 - 10 BRS camera platform + 10 photo position

- New Upper Stations: SPT
- 1 Athletes Services
 - 2 Unisex Toilets

- New Ski Jump Towers (HS143)
SPT / MPS / BRS
- 1 Male & Female Toilets 6sqm
 - 2 Equipment Control 10 sqm
 - 3 Athletes Staging Area 10 sqm
 - 4 Warm Up Area 35 sqm
 - 5 IVH Experience Lounge 35 sqm
 - 5 BRS camera platform 8 sqm

- New Ski Jump Towers (HS109)
SPT / BRS
- 1 Male & Female Toilets 6sqm
 - 2 Equipment Control 7sqm
 - 3 Staging Area 7sqm
 - 4 Warm Up Area 35sqm
 - 5 BRS camera platform 8sqm

RES Venue
Storage/ Workshop
50 sqm

Presentation Area (FOP)
100 sqm

Equipment Control
100 sqm

Olympic Family Stand
n. 145 + 4 + 4

OF / MiCo / Spect. Ticketed Seating
n. 330

Spectators Ticketed Seating
n. 515

BIO
15 sqm

Commentary Control Room (CCR)
60 sqm

Ticketed Standing Area (HS13 Sess.)
n. 1400 / 1400 sqm

Ticketed Standing Area (HS10 Sess.)
n. 1400 / 1400 sqm

Spectators Ticketed Seating
n. 1210

Workforce Check-in
75 sqm

Broadcast Compound
4065 sqm

Venue TEC Operations (VTO)
90 sqm

Tech. Storage
150 sqm

AV Bulk Storage
50 sqm

Pedestrian Screening (PSA2)
4 lanes / 50 sqm

Pedestrian Screening (PSA1)
6 lanes / 75 sqm

Vehicle Screening Area (VSA 1)
2 lanes + 1PSA / 150 sqm

Drivers Waiting
15 sqm

Box Office (TBO)
25 sqm

2_PSJ_OLY_00_AL2

DDS / ENG / PHP / TW / TS
2800 sqm

DDS Load Zone
OBSTW Load Zone - Workforce
ENG Load Zone
TS Staging Area



FONDAZIONE MILANO CORTINA 2026
ORGANISING COMMITTEE FOR THE
OLYMPIC AND PARALYMPIC WINTER GAMES

PIAZZA TRE TORRI, 3 - 20145 MILANO, ITALIA
www.milanocortina2026.org

© 2021 FONDAZIONE MILANO CORTINA 2026 - ALL RIGHTS RESERVED.
THIS DRAWING IS THE PROPERTY OF THE ORGANISING COMMITTEE FOR THE
2026 OLYMPIC AND PARALYMPIC WINTER GAMES AND IS STRICTLY CONFIDENTIAL.
IT IS NOT TO BE DISTRIBUTED, REPRODUCED OR ALTERED IN ANY WAY AS WHOLE OR IN PARTS
WITHOUT WRITTEN PERMISSION OF FONDAZIONE MILANO CORTINA 2026.
FONDAZIONE MILANO CORTINA 2026 SHALL HAVE NO RESPONSIBILITY OR LIABILITY FOR THE
SUITABILITY, ACCURACY, OR COMPLETENESS OF THE INFORMATION IT CONTAINS.
ALL DIMENSIONS AND LEVELS MUST BE VERIFIED ON SITE AND ANY DISCREPANCIES ARE TO BE
REPORTED TO FONDAZIONE MILANO CORTINA 2026 BEFORE PROCEEDING WITH ANY RELATED WORKS.

**PREDAZZO
OLYMPIC
VILLAGE**

LEGEND

AREA / FUNCTION	ROUTE / FLOW		
	Pedestrian	Vehicular	Entry Point
Field Of Play			
Athletes			
Olympic / Paralympic Family			
In Venue Hospitality *Experience			
Spectators			
Broadcast			
Press			
Security			
Venue Operations			
Ceremonies			
Unavailable / Not to be used			
Multiple Client Groups			
Parking Area			
Load Zone			
PSA Pedestrian Screening Area			
VSA Vehicles Screening Area			
Metro Station			

REVISIONS

No.	STATUS	DATE
1	Venue Design Book 1	15/11/2021
2	Venue Design Book 2	28/10/2022
3	Venue Design Book 3	15/12/2023

NOTES

KEY PLAN

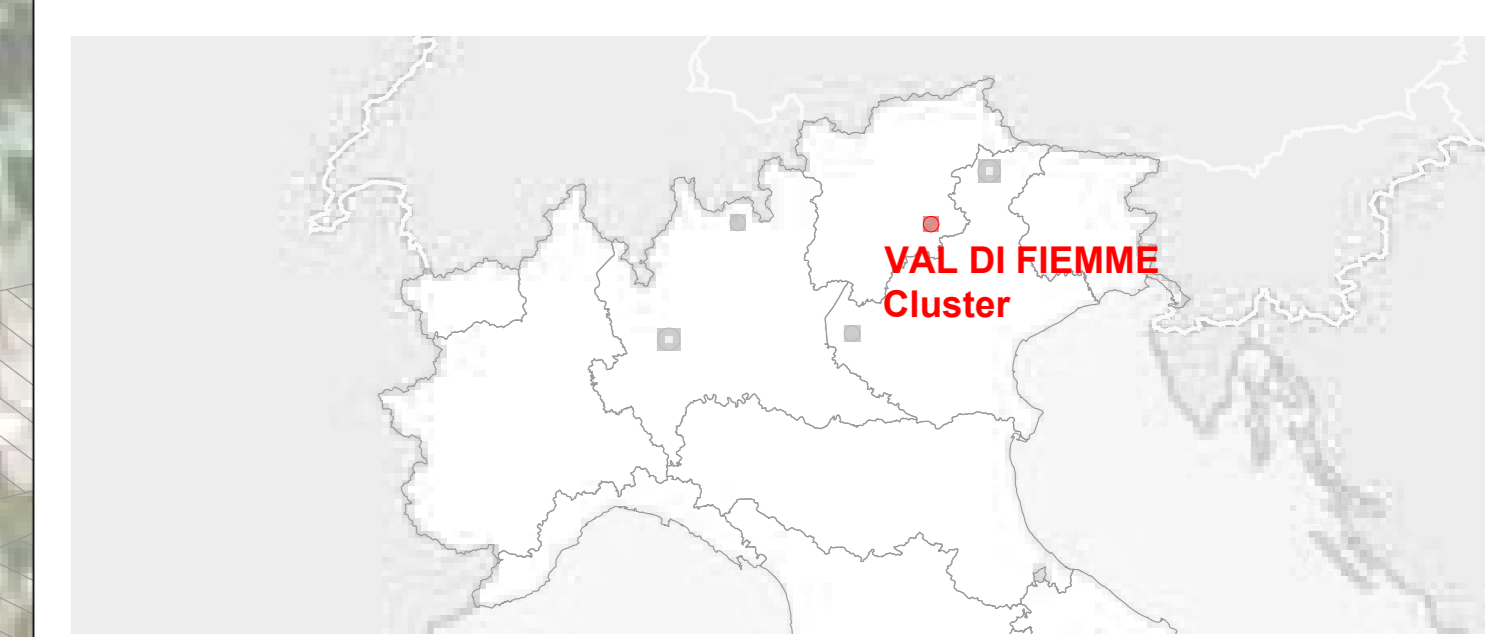

DRAWING CODE
3_PRV_NCO_00_AL0

DRAWING TITLE	DATE
Olympic Mode AERIAL VIEW	15/12/2023

STATUS	REVISION No.
VENUE DESIGN BOOK 3	3

SCALE @A0	
1:500	





FONDAZIONE MILANO CORTINA 2026
ORGANISING COMMITTEE FOR THE
OLYMPIC AND PARALYMPIC WINTER GAMES

PIAZZA TRE TORRI, 3 - 20145 MILANO, ITALIA
www.milancortina2026.org

© 2021 FONDAZIONE MILANO CORTINA 2026 - ALL RIGHTS RESERVED.
THIS DRAWING IS THE PROPERTY OF THE ORGANISING COMMITTEE FOR THE
2026 OLYMPIC AND PARALYMPIC WINTER GAMES AND IS STRICTLY CONFIDENTIAL.
IT IS NOT TO BE DISTRIBUTED, REPRODUCED OR ALTERED IN ANY WAY AS WHOLE OR IN PARTS
WITHOUT WRITTEN PERMISSION OF FONDAZIONE MILANO CORTINA 2026.
FONDAZIONE MILANO CORTINA 2026 SHALL HAVE NO RESPONSIBILITY OR LIABILITY FOR THE
SUITABILITY, ACCURACY, OR COMPLETENESS OF THE INFORMATION IT CONTAINS.
ALL DIMENSIONS AND LEVELS MUST BE VERIFIED ON SITE AND ANY DISCREPANCIES ARE TO BE
REPORTED TO FONDAZIONE MILANO CORTINA 2026 BEFORE PROCEEDING WITH ANY RELATED WORKS.

**PREDAZZO
OLYMPIC
VILLAGE**

LEGEND

AREA / FUNCTION	ROUTE / FLOW		
	Pedestrian	Vehicular	Entry Point
Field Of Play	→	→	→
Athletes	→	→	→
Olympic / Paralympic Family	→	→	→
In Venue Hospitality *Experience	→	→	→
Spectators	→	→	→
Broadcast	→	→	→
Press	→	→	→
Security	→	→	→
Venue Operations	→	→	→
Ceremonies	→	→	→
Unavailable / Not to be used	→	→	→
Multiple Client Groups	→	→	→

▨ Parking Area	—○— Venue Secure Perimeter
▨ Load Zone	—○— Internal Division / Fence
▨ PSA Pedestrian Screening Area	—○— Inner Perimeter
▨ VSA Vehicles Screening Area	—○— Inner Perimeter
▨ Metro Station	—x— Existing Division / Fence

REVISIONS

No.	STATUS	DATE
1	Venue Design Book 1	15/11/2021
2	Venue Design Book 2	28/10/2022
3	Venue Design Book 3	15/12/2023

NOTES

KEY PLAN

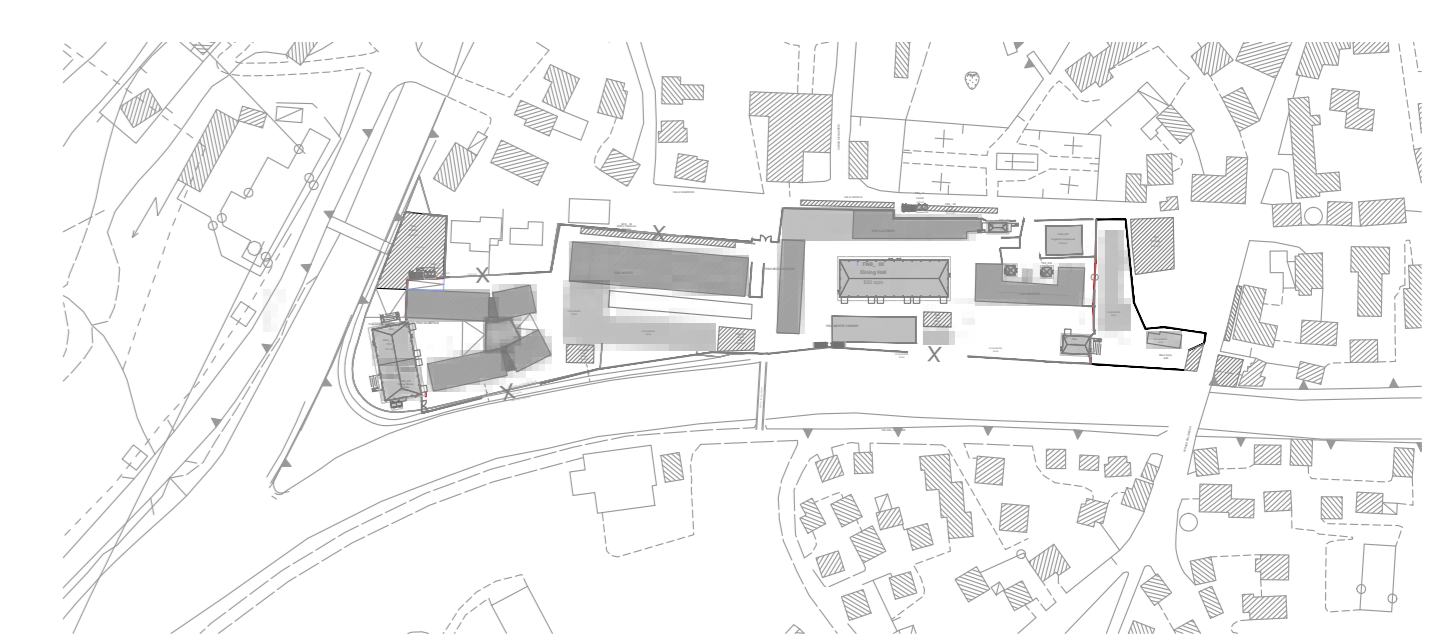

DRAWING CODE

3_PRV_NCO_00_AL1

DRAWING TITLE

**Olympic Mode
MASTERPLAN**

DATE

15/12/2023

STATUS

VENUE DESIGN BOOK 3

REVISION No.

3

SCALE @A0

1:500

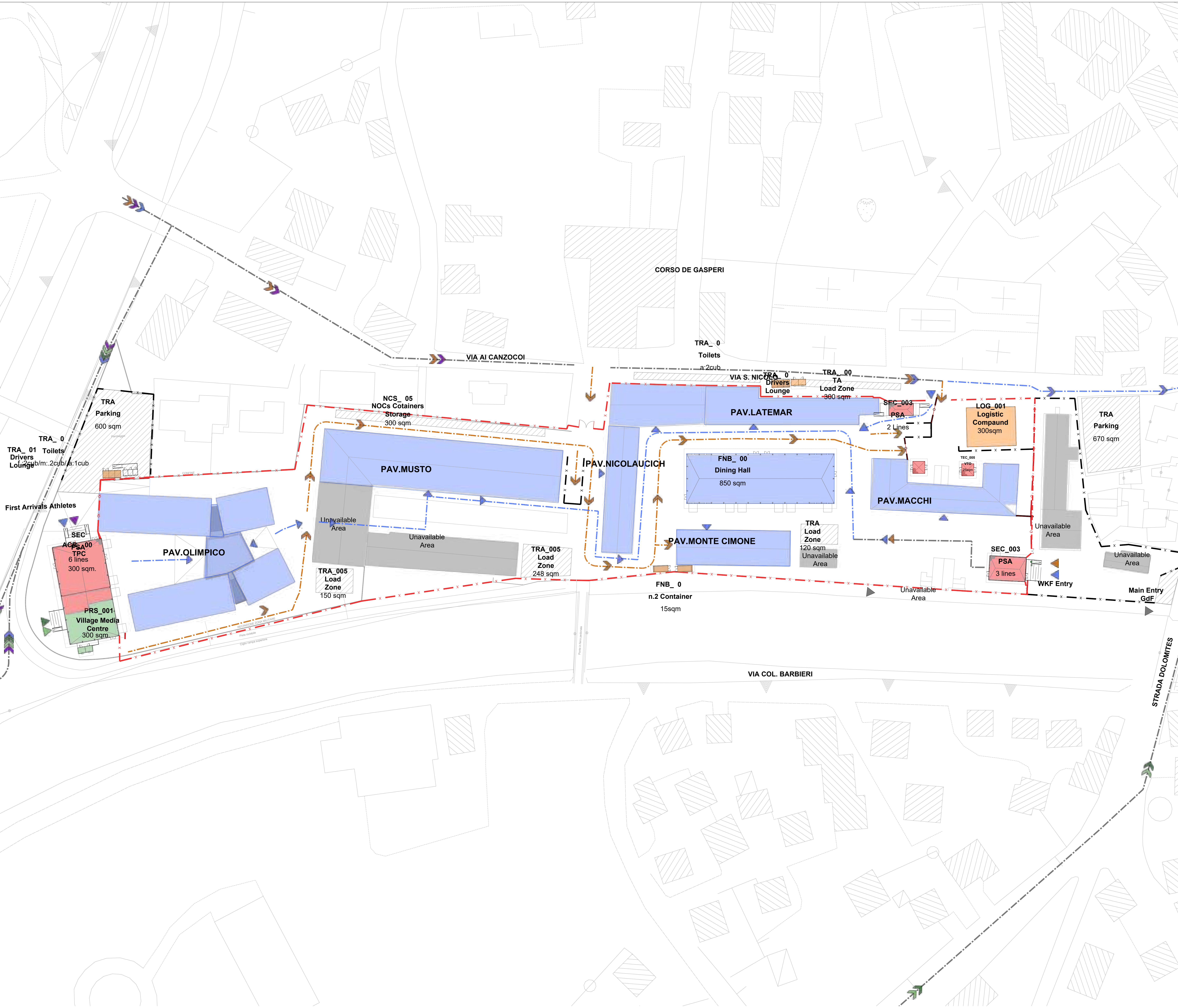
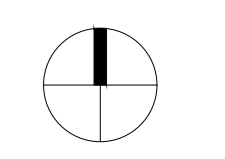
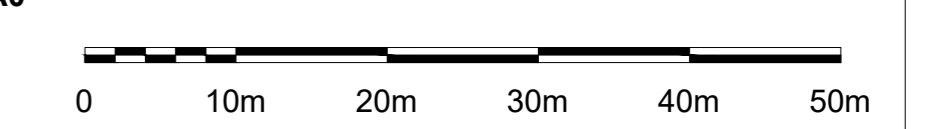

PREDAZZO PARALYMPIC VILLAGE

LEGEND

AREA / FUNCTION	ROUTE / FLOW		
	Pedestrian	Vehicular	Entry Point
Field Of Play			
Athletes			
Olympic / Paralympic Family			
In Venue Hospitality *Experience			
Spectators			
Broadcast			
Press			
Security			
Venue Operations			
Ceremonies			
Unavailable / Not to be used			
Multiple Client Groups			
Parking Area			
Load Zone			
PSA Pedestrian Screening Area			
VSA Vehicles Screening Area			
Metro Station			

REVISIONS

No.	STATUS	DATE
1	Venue Design Book 1	15/11/2021
2	Venue Design Book 2	28/10/2022
3	Venue Design Book 3	15/12/2023

NOTES

KEY PLAN

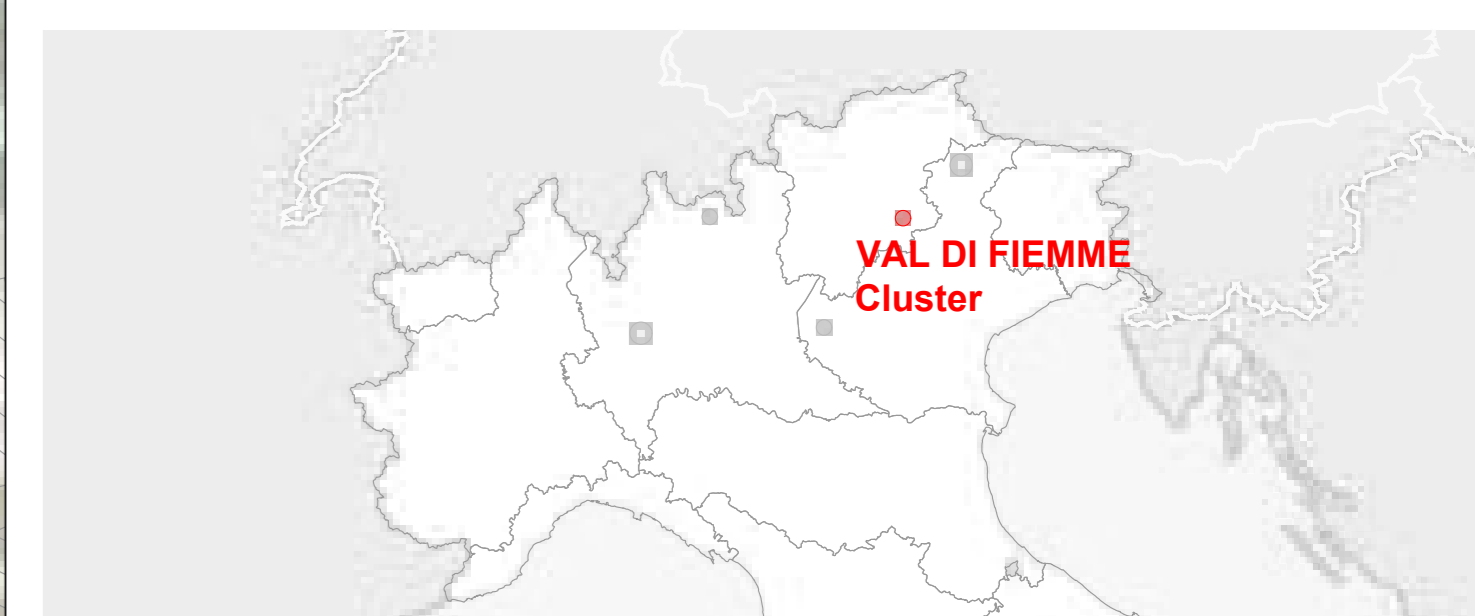

DRAWING CODE

3_PRV_NPC_00_AL0

DRAWING TITLE

Olympic Mode
AERIAL VIEW

DATE

15/12/2023

STATUS

VENUE DESIGN BOOK 3

REVISION No.

3

SCALE @A0

1:500

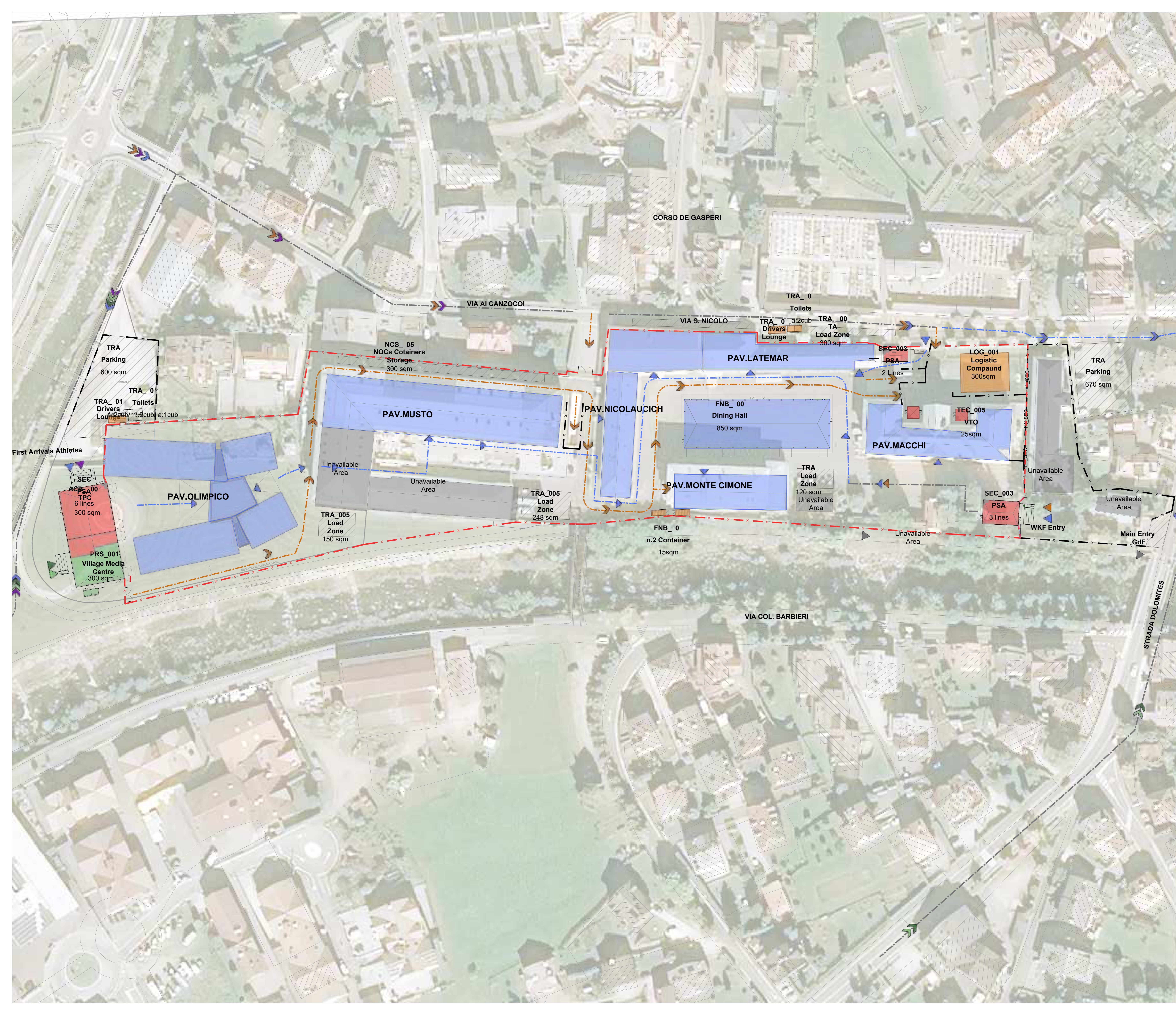
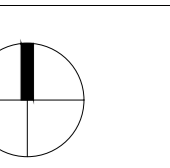
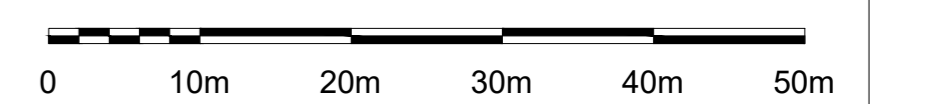

© 2021 FONDAZIONE MILANO CORTINA 2026 - ALL RIGHTS RESERVED.
THIS DRAWING IS THE PROPERTY OF THE ORGANISING COMMITTEE FOR THE
2026 OLYMPIC AND PARALYMPIC WINTER GAMES AND IS STRICTLY CONFIDENTIAL.
IT IS NOT TO BE DISTRIBUTED, REPRODUCED OR ALTERED IN ANY WAY AS WHOLE OR IN PARTS
WITHOUT WRITTEN PERMISSION OF FONDAZIONE MILANO CORTINA 2026.
FONDAZIONE MILANO CORTINA 2026 SHALL HAVE NO RESPONSIBILITY OR LIABILITY FOR THE
SUITABILITY, ACCURACY, OR COMPLETENESS OF THE INFORMATION IT CONTAINS.
ALL DIMENSIONS AND LEVELS MUST BE VERIFIED ON SITE AND ANY DISCREPANCIES ARE TO BE
REPORTED TO FONDAZIONE MILANO CORTINA 2026 BEFORE PROCEEDING WITH ANY RELATED WORKS.

PREDAZZO PARALYMPIC VILLAGE

LEGEND

AREA / FUNCTION	ROUTE / FLOW		
	Pedestrian	Vehicular	Entry Point
Field Of Play	→	→	→
Athletes	→	→	→
Olympic / Paralympic Family	→	→	→
In Venue Hospitality *Experience	→	→	→
Spectators	→	→	→
Broadcast	→	→	→
Press	→	→	→
Security	→	→	→
Venue Operations	→	→	→
Ceremonies	→	→	→
Unavailable / Not to be used	→	→	→
Multiple Client Groups	→	→	→
Parking Area	→	→	→
Load Zone	→	→	→
PSA Pedestrian Screening Area	→	→	→
VSA Vehicles Screening Area	→	→	→
M Metro Station	→	→	→
Venue Secure Perimeter	→	→	→
Internal Division / Fence	→	→	→
Inner Perimeter	→	→	→
Existing Division / Fence	→	→	→

REVISIONS

No.	STATUS	DATE
1	Venue Design Book 1	15/11/2021
2	Venue Design Book 2	28/10/2022
3	Venue Design Book 3	15/12/2023

NOTES



DRAWING CODE
3_PRV_NPC_00_AL1

DRAWING TITLE Olympic Mode MASTERPLAN	DATE 15/12/2023
STATUS VENUE DESIGN BOOK 3	REVISION No. 3
SCALE @A0 1:500	

